

CD050 potentiometric output – Measurement range 0 up to 1250 mm

Specifications:

Measurement range	0 up to 1250 mm
Output signal	1kΩ (other values on demand)
Resolution	Quasi infinite (depends on the operating system)
Material	Body and cover - Aluminium (RohS) Measuring cable – Stainless steel
Cable diameter	0,51 mm
Detection element	Precision potentiometer
Connection	Male connector M16 – DIN 3 pin Male connector M12 – 4 pin PVC cable – 4 wires
Standard linearity	+/- 0,25% f.s. – stroke \leq500mm +/- 0,15% f.s. – stroke $>$500mm +/- 0,10% f.s. – stroke $>$500mm (option)
Protection class	IP54 (option IP67)
Max. Velocity	10 M/S
Max. Acceleration	40 M/S² (before cable deformation)
Weight	\approx 700 g
Operating temperature	-20° to +80°C
Storage temperature	-30° to +80°C

Cable forces

Measurement range in mm	Min. pull-out force	Max. pull-out force
50	\approx 6,40 N	\approx 6,50 N
100	\approx 6,30 N	\approx 6,50 N
250	\approx 6,00 N	\approx 6,50 N
500	\approx 5,50 N	\approx 6,50 N
750	\approx 5,00 N	\approx 6,50 N
1000	\approx 4,50 N	\approx 6,50 N
1200	\approx 4,00 N	\approx 6,50 N
1250	\approx 4,00 N	\approx 6,50 N

Ordering reference:

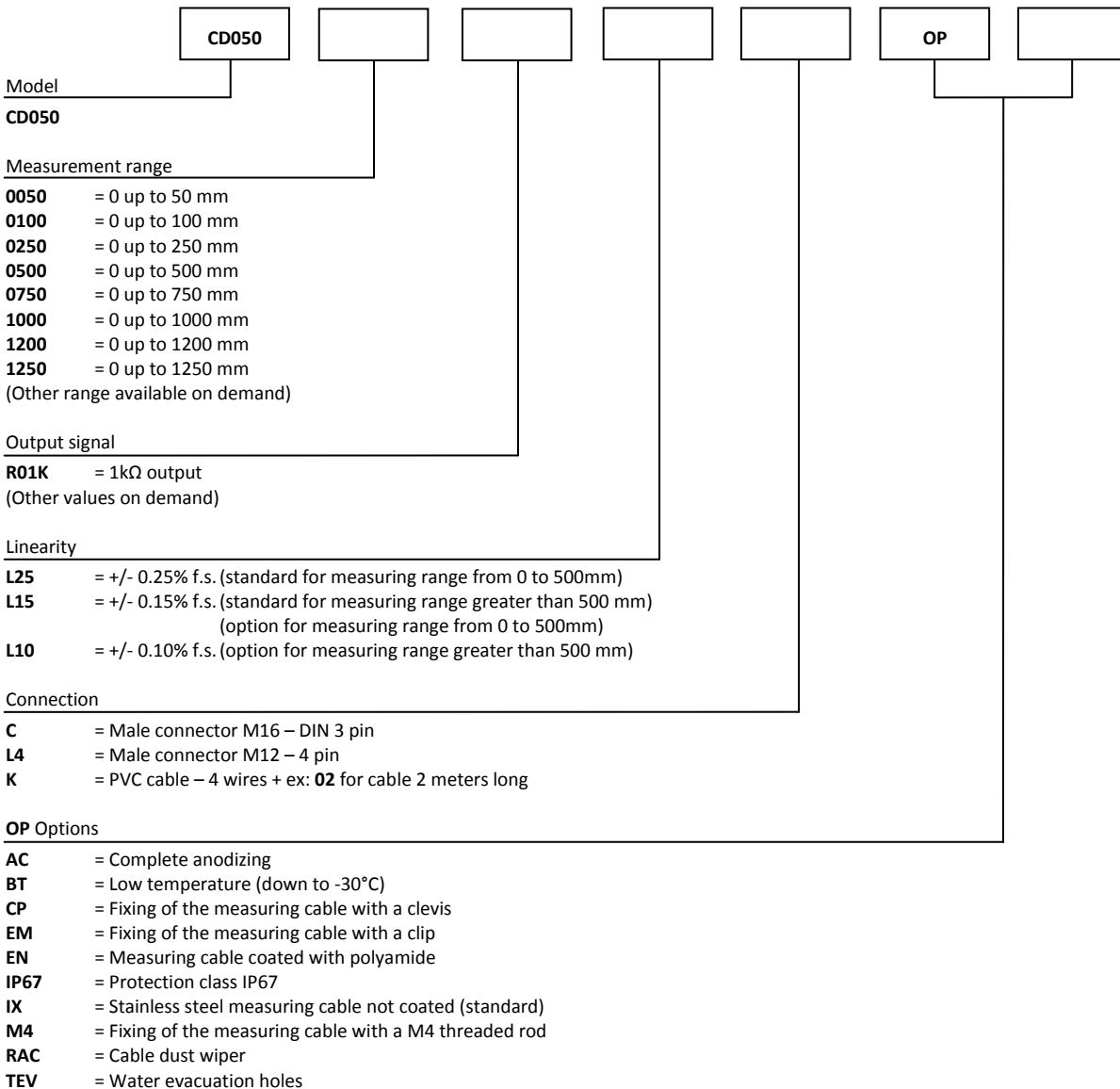

Reference example: CD50-0750-R01R-L15-K02-OP-AC-EM

Made in France

CD050 potentiometric output – Measurement range 0 up to 1250 mm

Dimensional Drawing

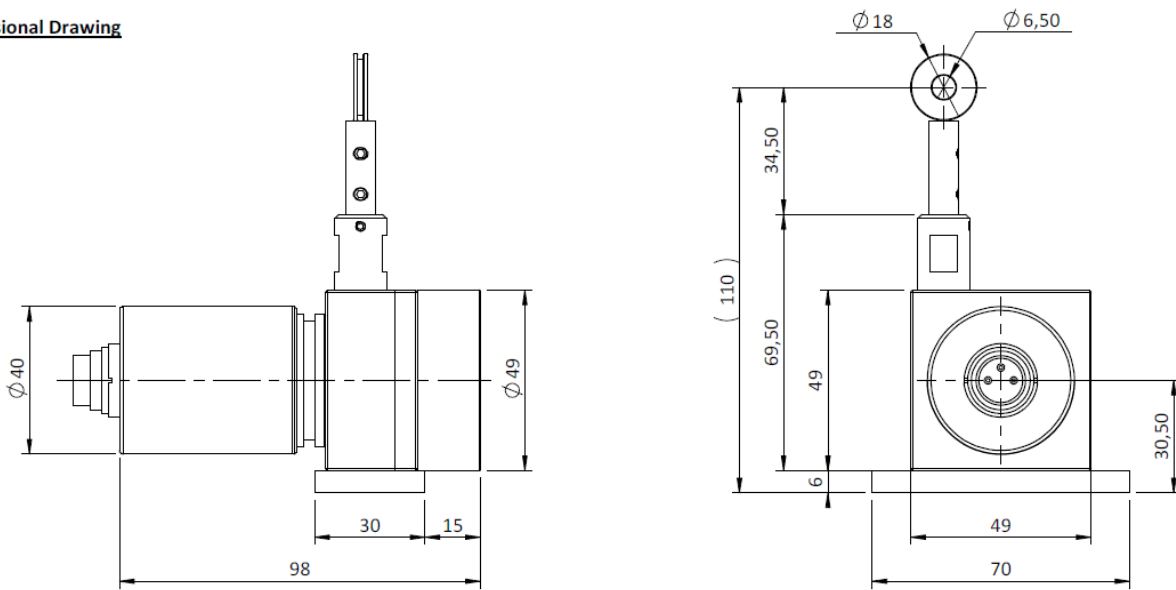

K connection
(PVC cable - 4 wires)

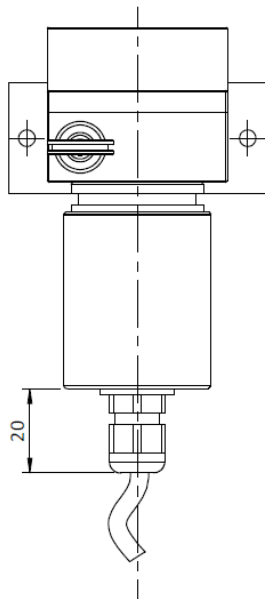

L4 connection
(connector M12 - 4 pin)

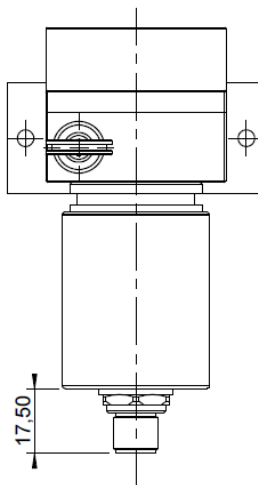

C connection
(Connector M16 - DIN 3 pin)

